

MODEL CK7100-X Conversion Kit (warm gray)

USE CK7100-X CONVERSION KIT TO CONVERT 7100X A-FRAME LADDER TO 6100X INPOOL LADDER

ASSEMBLY AND INSTRUCTION MANUAL

Parts List

2 - Adjustable Tube Handrails (wg) 2 - Adjustable Tubes (wg)
2 - Mounting Block (wg)

Hardware Pack

14 - #10 x 1-1/4" screw



7100X A-Frame Ladder

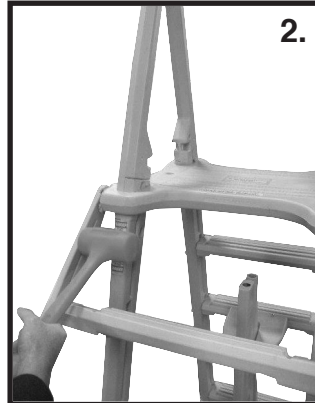

Using a rubber mallet remove the swing-up portion of ladder from ladder platform tabs.



Swing-up section removed.



Remove the (2) two screws from the top of hand rails.

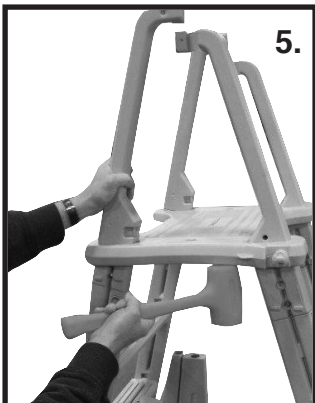

Remove the outside ladder section by tapping on the underside of platform until ladder separates.

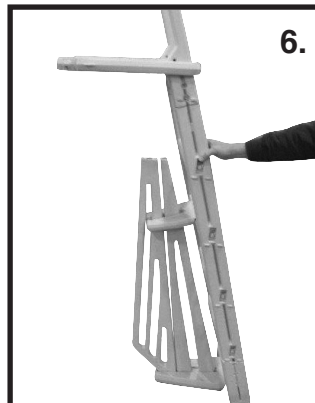

Use only in pool section of ladder with anti-entrapment barrier attached.

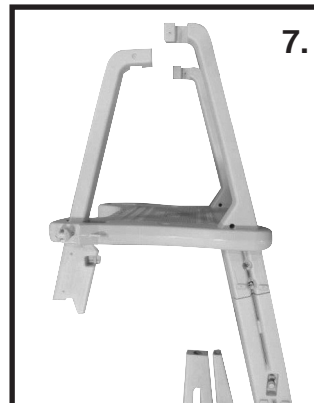

Slide tube rails up through bottom of platform until seated on tabs.

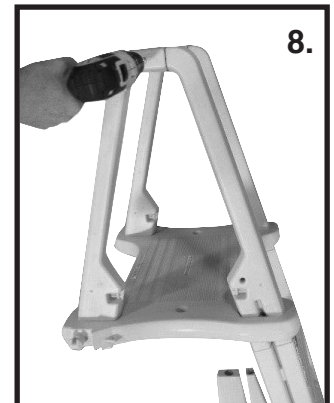

Re-install the (2) two hand rail screws.

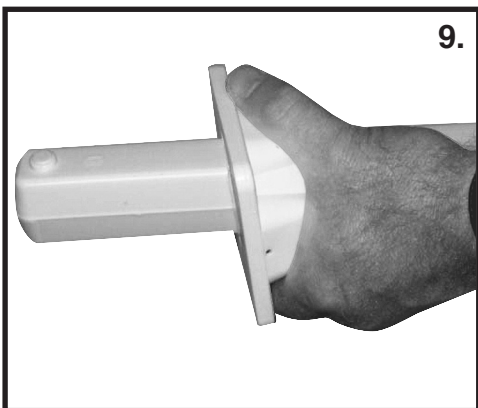

Slide the mounting block over the adjustable tube until seated on the tabs.

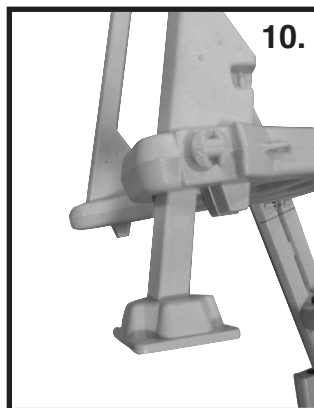

Slide adjustable tubes into ladder rails.



Complete 6100X Ladder.

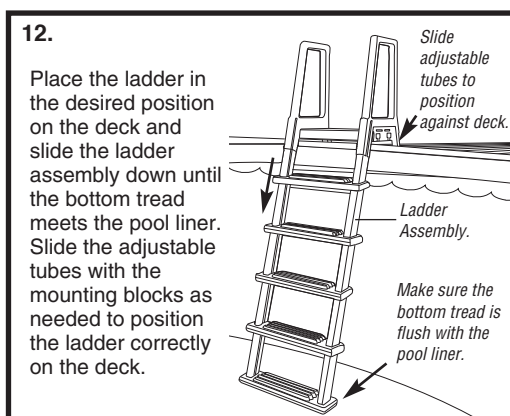

12.

Place the ladder in the desired position on the deck and slide the ladder assembly down until the bottom tread meets the pool liner. Slide the adjustable tubes with the mounting blocks as needed to position the ladder correctly on the deck.

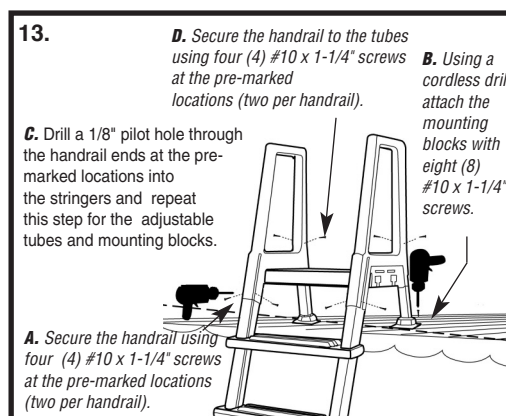

13.

A. Secure the handrail using four (4) #10 x 1-1/4" screws at the pre-marked locations (two per handrail).

C. Drill a 1/8" pilot hole through the handrail ends at the pre-marked locations into the stringers and repeat this step for the adjustable tubes and mounting blocks.

D. Secure the handrail to the tubes using four (4) #10 x 1-1/4" screws at the pre-marked locations (two per handrail).

B. Using a cordless drill attach the mounting blocks with eight (8) #10 x 1-1/4" screws.



MADE IN THE U.S.A. by:
CONFER
plastics inc.

97 Witmer Road
North Tonawanda, NY 14120-2421
Toll Free U.S. 800-635-3213
FAX: 716-694-3102
www.conferladders.com