



# APC4000A

SUBMERSIBLE POOL COVER PUMP

OPERATIONS MANUAL

[WWW.ECOAQUAPRO.COM](http://WWW.ECOAQUAPRO.COM)

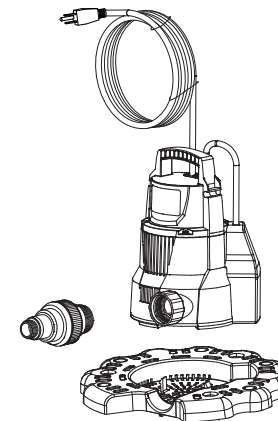

**▲ WARNING:** Read carefully and understand all ASSEMBLY AND OPERATION INSTRUCTIONS before operating. Failure to follow the safety rules and other basic safety precautions may result in serious personal injury

If you have any **QUESTIONS, PROBLEMS, MISSING PARTS**, please call our customer service department at 877-278-2797 before returning to your retailer

## PARTS DIAGRAM

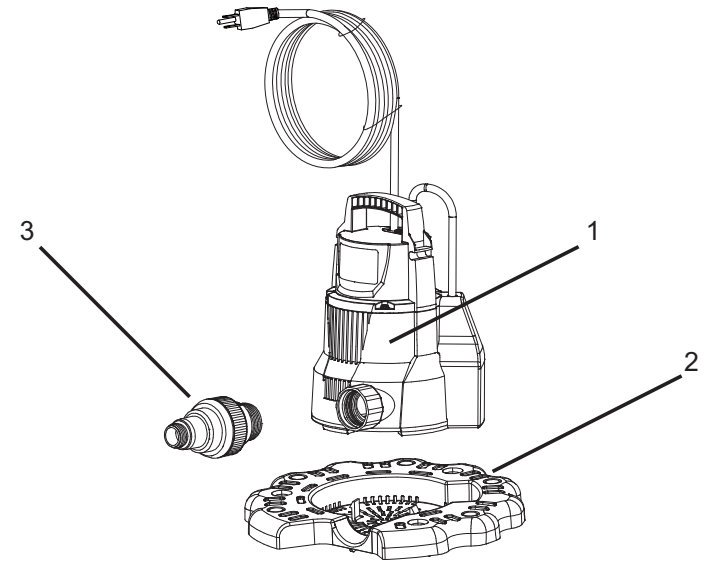

## PARTS LIST

Part No.	Description	Part Number
1	pump	
2	bottom base	34000-001
3	check valve adapter	34001-001

## OPERATION INSTRUCTIONS

**▲WARNING:** Risk of electric shock. Can shock, burn or kill. Do not handle pump or pump motor with wet hands or when standing on wet or damp surface, or in water. Disconnect power from pump before handling, servicing, or attempting to repair pump.

The motor is equipped with an automatically resetting thermal overload protector. If the motor gets too hot, the overload protector will stop the motor before it is damaged. When the motor has cooled sufficiently, the overload protector will reset itself and the motor will restart.

**NOTICE:** If the overload protector stops the pump repeatedly, disconnect the power from the pump and check it to find the problem. Low voltage, clogged impeller, too much back pressure in the discharge hose, or extended running of pump with no load, can all cause overheating.

## TROUBLESHOOTING

**Note: Do not disassemble the motor housing. This motor has NO repairable internal parts and disassembling may cause an oil leak or dangerous electrical wiring issues.**

Problem	Possible Cause	Corrective Action
Pump won't start or run	<ol style="list-style-type: none"> <li>1. Blown fuse</li> <li>2. Low line voltage</li> <li>3. Defective motor</li> <li>4. The water level is too low</li> </ol>	<ol style="list-style-type: none"> <li>1. If blown, replace with fuse of proper size.</li> <li>2. If voltage under recommended minimum, check size of wiring from main switch on property. If OK, contact power company.</li> <li>3. Replace pump.</li> <li>4. Allow the water level to rise to 2 in. or more.</li> </ol>
Pump operates but delivers little or no water	<ol style="list-style-type: none"> <li>1. Low line voltage</li> <li>2. Something caught in impeller</li> <li>3. Small diameter garden hose or long discharge line</li> <li>4. Check valve installed without vent hole</li> </ol>	<ol style="list-style-type: none"> <li>1. Call power company.</li> <li>2. Clean out impeller.</li> <li>3. Use larger diameter garden hose or 1" flexible pipe. Eliminate any excess hose. Short hoses work best.</li> <li>4. Drill a 1/16" - 1/8" dia. hole between pump discharge &amp; check valve.</li> </ol>

## TECHNICAL SPECIFICATIONS

### Model: APC4000A

Property	Specifications
Voltage	115V/60Hz
Horse Power	1/4HP
Amps	3A
Max. Head (ft.)	26 ft.
Max. Flow (GPH)	3000
Discharge Size (in.)	3/4 in.
Power cord length (ft.)	25 ft.

## PERFORMANCE

Model	GPH of water @ Total Ft. Head	
	0 ft.	Max. Head
APC4000A	3000	26ft

For best performance, the maximum recommended hose length is 50 ft. with diameter no smaller than 5/8". The pumping capacity or water flow rate of any pump depends on several factors. The larger the inside diameter and the shorter the length of hose, the less pressure that is lost (or the larger the flow rate). If the hose runs uphill or is extra-long, use a larger diameter hose or rigid pipe.

## ▲ SAFETY INFORMATION

### ▲ WARNING

- This product and related accessories contain chemicals known to the State of California to cause cancer, birth defects or other reproductive harm. For more information, please visit: [www.P65Warnings.ca.gov](http://www.P65Warnings.ca.gov)
- Risk of sudden starts: Can cause electrical shock and personal injury. The pump motor is equipped with an automatically resetting thermal protector and may restart unexpectedly.
- DO NOT plug in the pump while standing in water or on a wet or damp surface.
- DO NOT pick up the pump by the power cord. Protect the electrical cord from sharp objects, hot surfaces, oil, and chemicals. Avoid kinking the cord.
- Unplug the pump before servicing it or attempting to clean it.
- Secure the discharge hose before starting the pump. An unsecured discharge hose may whip, which can cause personal injury and property damage.
- Keep the pump, base, and inlet screen free of debris and foreign objects.
- This pump has two air bleeds built within. During operation, a small amount of water could be seen at either bleed. Please reference image on page 4 for locations.
- Extension cords may not deliver sufficient voltage to the pump motor. Extension cords present a life-threatening safety hazard if the insulation becomes damaged or the connection ends fall into water.

## PREPARATION

- ▲ **WARNING:** Always use handle to lift pump. Never use power cord to lift pump. To avoid skin burns, unplug and allow time for the pump to cool after periods of extended use.

Estimated Assembly Time (New installation): 5 minutes

## INSTALLATION INSTRUCTIONS

1. Pump should always stand upright on base when operating. Do not suspend pump by means of discharge hose or power cord. Keep pump inlet screen clear.
2. To install a garden hose, first install check valve adapter provided with pump. Tighten the check valve adapter 100%, stopping once the word "TOP" of the adapter is on TOP (facing upward).

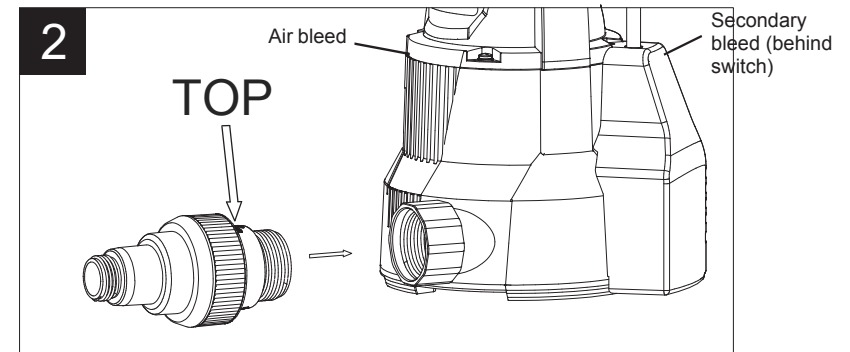

3. Power Supply: Pump is designed for 115V, 60 HZ. Operation and requires an individual branch circuit of 15 amperes or more capacity. It is supplied with a 3-wire cord set with grounding-type plug for use in a GFCI outlet. For safety, pump should always be electrically grounded to a suitable electrical ground such as a grounded water pipe or a properly grounded metallic raceway or ground wire system. Please follow local laws & codes for proper install. Do not cut off the round grounding prong.

**WARNING:** Risk of sudden starts. Can cause electrical shock and personal injury. The pump motor is equipped with automatic resetting thermal protector and may restart unexpectedly. Protector tripping is indication of motor overloading as a result of operating pump at high pressure, excessively high or low voltage, inadequate wiring incorrect motor connections, or a defective motor or pump.

### Automatic Operation

- The pump will only turn on if there is approximately 2 in. of water around the pump. Water must make contact with the sensor probes of the pump in order for it to turn on.
- When the pump removes water down to approximately 1/2 in., the pump will run for an additional 10 seconds and then turn off.  
**Note:** If the pump does not turn off, remove the pump and check to make sure that water or other debris is not still contacting the sensor probes.
- The pump can remain plugged in and will automatically turn back on when water reaches approximately 2 in. again.